

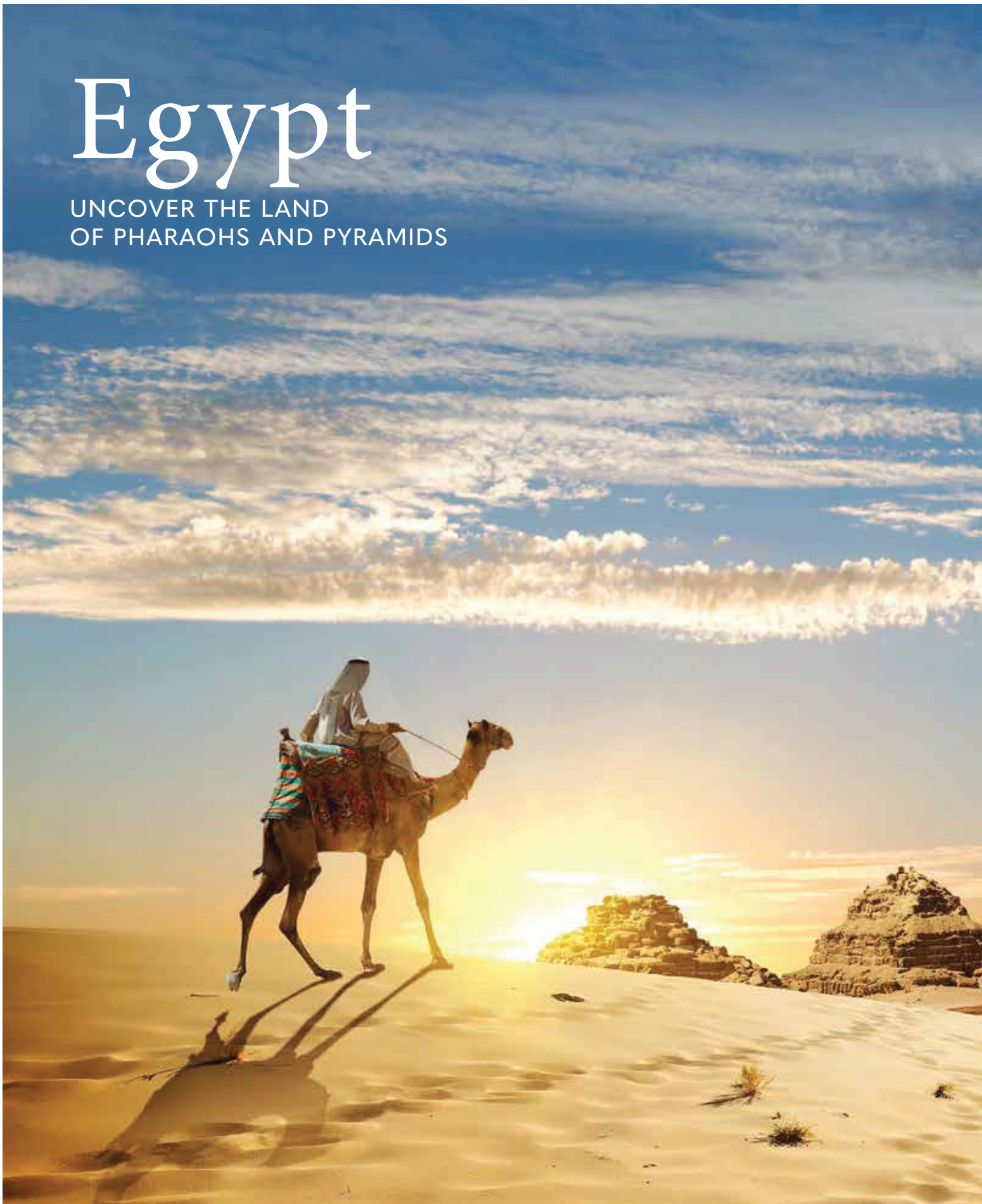

# Egypt

UNCOVER THE LAND  
OF PHARAOHS AND PYRAMIDS





A large, ancient pyramid made of golden-brown stone blocks stands prominently in a vast desert landscape. The pyramid is the central focus, with its apex pointing towards the top right. To its left, a smaller, more eroded pyramid is visible in the distance. The foreground is a flat, sandy desert floor. The sky is a deep blue, filled with soft, white clouds that are illuminated from below, creating a warm, golden glow. The overall scene is one of ancient grandeur and timeless beauty.

*"We journey up the storied Nile;  
the timeless water seems to smile...  
We catch the breeze and sail away,  
Along the dawning of the day,  
Along the East, wherein the morn  
of life and truth was gladly born."*

—Henry Abbey,  
from his poem "Along the Nile"





TEMPLE OF PHILAE ON THE NILE RIVER, ASWAN, EGYPT

## EGYPT: THE GIFT OF THE NILE

Considered one of the cradles of civilisation, Egypt has been dependent on the Nile River since ancient times. Without its water, rich soil, papyrus reeds, fish and fowl life, Egyptian culture would never have existed. It was from these natural resources that one of the greatest civilisations emerged, with a complex belief system, mystifying rituals, brilliant artistry, ingenious feats of engineering and awe-inspiring archaeological treasures that changed the course of history. Perhaps this is why the Greek historian Herodotus called Egypt the “Gift of the Nile,” since without its water, the Egyptian empire would not have emerged.

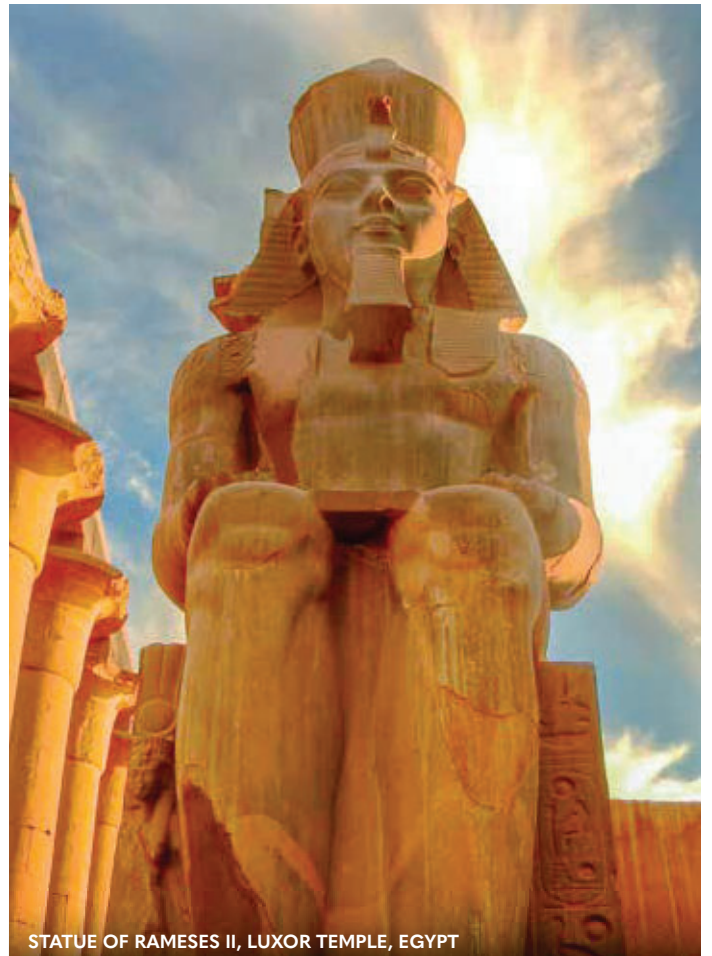

STATUE OF RAMESES II, LUXOR TEMPLE, EGYPT



# LUXOR: THE WORLD'S GREATEST OPEN-AIR MUSEUM

The perfect gateway for your Nile River cruise is the UNESCO-designated city of Luxor, one of the most unique settings in the world, encompassing both Egypt's rich past and modern charm. Formerly known as Thebes and once considered the most powerful city of the ancient world, Luxor contains about a third of the world's most valuable monuments and antiquities. On the Nile's Left Bank, you'll explore the temples of Karnak and Luxor, and marvel at the one-and-a-half mile Avenue of Sphinxes. On the Nile's Right Bank, the Valley of the Kings and the Valley of the Queens await. The former holds dozens of ancient tombs, including that of King Tutankhamun, while the latter is equally priceless and holds the tomb of Queen Nefertari, the beloved royal wife of Rameses II.



KARNAK TEMPLE, LUXOR

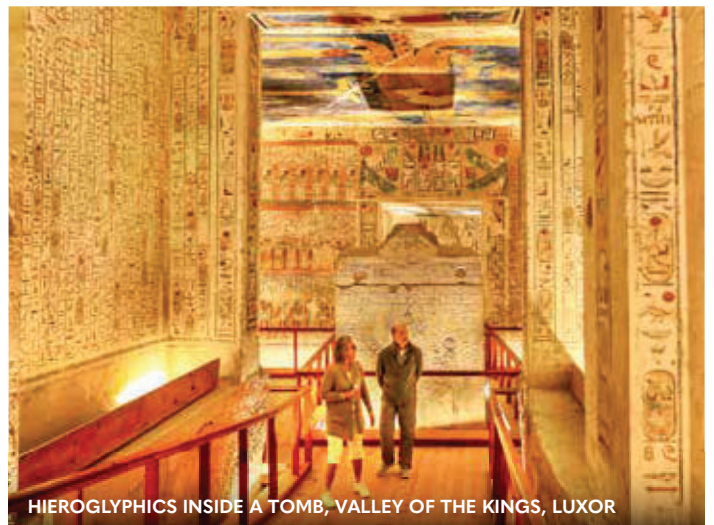

HIEROGLYPHICS INSIDE A TOMB, VALLEY OF THE KINGS, LUXOR

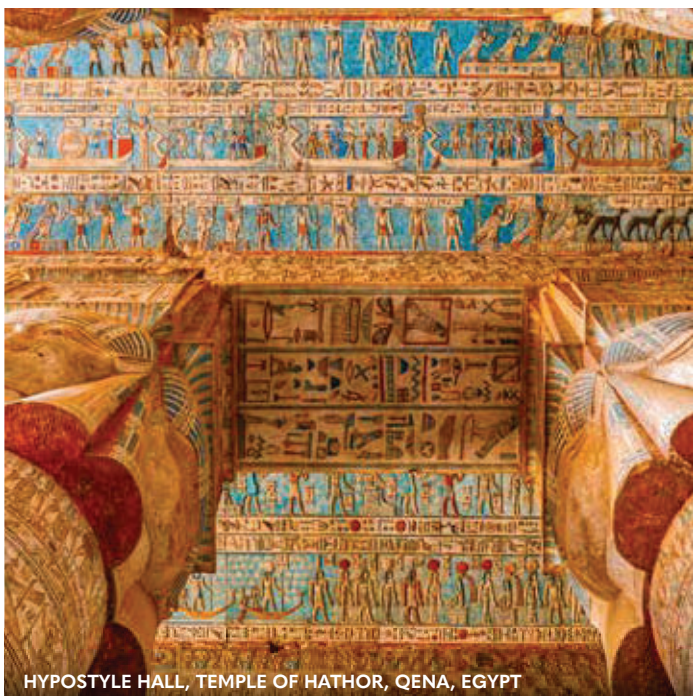

HYPOSTYLE HALL, TEMPLE OF HATHOR, QENA, EGYPT

## THE MYSTERIES OF ANCIENT EGYPT

While travelling with AmaWaterways along the Nile River from Luxor to Aswan, you will discover a dazzling array of ancient monuments, tombs and temples. Experience some of Egypt's greatest cult temples devoted to a renowned god or goddess. From the Temple of Horus, the "Falcon God," to the temple of the goddess Hathor, the most visually stunning and best-preserved temple in Egypt, the treasures you uncover will leave you in awe.





NUBIAN VILLAGER, ASWAN, EGYPT

## AUTHENTIC AND EXCLUSIVE EXPERIENCES

Your specially curated 11-night *Secrets of Egypt & the Nile* itinerary includes a variety of authentic experiences that immerse you in the history and culture of Egypt, some of which are exclusively available to AmaWaterways guests. Best of all, each excursion listed on the itinerary, including the enriching experiences on the next page, is included in your river cruise fare.



EGYPTIAN MUSEUM AND KING TUT'S TREASURES, CAIRO



## NUBIAN VILLAGE VISIT

Nubia reflects a great heritage with a history dating back thousands of years. In ancient tomb paintings, Nubians were often depicted as traders who were sophisticated and served as major merchants for gold, ivory and ebony. During your exclusive visit to a Nubian village, you will share a delicious lunch – and the warm, welcoming spirit of the people you meet will outshine even the most vivid colours uniquely splashed across the exterior walls of their homes.



VIVIDLY PAINTED HOMES, NUBIAN VILLAGE, ASWAN

## EXCLUSIVE ACCESS TO THE TOMB OF QUEEN NEFERTARI

Nefertari, which means “the most beautiful of them all,” was the beloved royal wife of Rameses II, who built this tomb for her. Known as QV66, this tomb is considered one of the largest and most beautiful in the Valley of the Queens. And it is here where you be offered exclusive access inside to see its brilliantly preserved wall paintings up close – a special experience reserved just for AmaWaterways guests.



WALL PAINTING, TOMB OF QUEEN NEFERTARI, VALLEY OF THE QUEENS

## PRIVATE LUNCH AT ABDEEN PRESIDENTIAL PALACE

Built in the 19th century and considered one of the world’s most luxurious palaces, Abdeen Palace is one of the official residences and workplaces of the President of Egypt. It consists of multiple museums and an incredible volume of paintings adorns the walls in almost every room, along with a collection of clocks, many of which are decorated with pure gold. Following your exclusive private tour, you will be treated to a very special lunch at the palace you will not soon forget.



ABDEEN PRESIDENTIAL PALACE, CAIRO, EGYPT





THE CHEF'S AL FRESCO RESTAURANT, AMADAHLIA

## A PALATE-PLEASING JOURNEY

Immersed in history and tradition, Egyptian cuisine is quite varied and shares similarities with its Mediterranean counterparts – but with a unique twist. Hummus, baba ghanoush, falafel, rice-stuffed grape leaves, exquisite cheese and baklava are staples of Egyptian cuisine, along with delicious meals prepared with fresh fish, meat, vegetables, legumes and of course exotic spices. You will be treated to your choice of exceptional Egyptian dishes as well as Western favourites when dining in the Main Restaurant on board.



ENJOY REGIONALLY-INSPIRED CUISINE, SUCH AS HUMMUS



## THE CHEF'S TABLE

Indulge in a multi-course tasting menu one special evening with AmaWaterways' signature Chef's Table experience – included in the price of your river cruise and land journey. On board *AmaDahlia*, this top-notch dining event takes place on the Sun Deck in the open air at The Chef's Al Fresco Restaurant, where beautifully patterned fabrics and lamps with designs and colours reflective of the region complement the experience as you sail down the Nile. When she debuts in 2024, *AmaLilia* will feature an interior Chef's Table specialty restaurant.

## REGIONALLY-INSPIRED ENTERTAINMENT

Immerse yourself in the vibrant culture of the region with special entertainment on board either the stunning *AmaDahlia* or exquisite *AmaLilia*. Be mesmerised by the rhythmic movement of an intriguing belly dance performance, don a traditional galabeya for a party one evening, and enjoy an authentic Darawish show.

## ENHANCE YOUR BEST SELF

Both of our ships in Egypt offer a well-equipped fitness centre for guests who wish to keep up with their active lifestyle on board – or perhaps work off the delicious cuisine they have enjoyed on board! In addition, for the ultimate pampering on board, both nail salons and massage rooms are available on board, with a variety of rejuvenating services offered for a nominal fee.



CO-FOUNDERS RUDI SCHREINER AND KRISTIN KARST ENJOYING THE GALABEYA PARTY ON BOARD

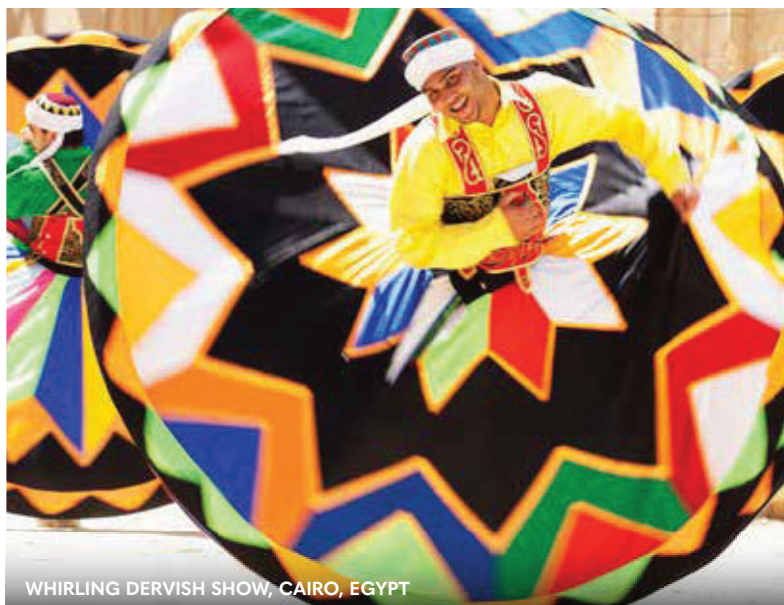

WHIRLING DERVISH SHOW, CAIRO, EGYPT



SUN DECK AND POOL, AMADAHLIA



# JOIN US, STAY AWHILE



GREAT SPHINX OF GIZA, CAIRO, EGYPT

## INCLUDED IN YOUR 11-NIGHT JOURNEY: CAIRO

There are many cities that blend the Old World and the new, and then there is Cairo, Egypt's capital, located on the banks of the Nile River. It is a city where towering skyscrapers overlook 1,000-year-old monuments and is home to the last of the Seven Wonders of the Ancient World still standing, the Great Pyramids, completed around 2540 B.C. Cairo is also one of the world's oldest Islamic cities and is home to stunning Islamic architecture, earning it the nickname "the City of a Thousand Minarets."

During your 11-night *Secrets of Egypt & the Nile* itinerary, we include three nights in Cairo pre-cruise and one night in Cairo post-cruise to give you ample time to explore the pyramids, the Egyptian Museum with King Tut's treasures, the Old City of Cairo and Abdeen

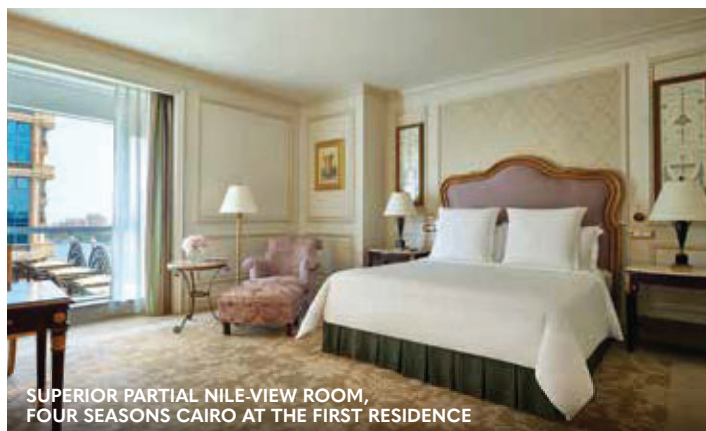

SUPERIOR PARTIAL NILE-VIEW ROOM,  
FOUR SEASONS CAIRO AT THE FIRST RESIDENCE



OPEN-AIR SWIMMING POOL,  
FOUR SEASONS CAIRO AT THE FIRST RESIDENCE



THE ST. REGIS CAIRO

Presidential Palace. At the end of each exhilarating day, you will return to luxury at either the Four Seasons Cairo at the First Residence or The St. Regis Cairo, both located along the Nile River. Each striking property features several exceptional restaurants, a spa and fitness centre and an open-air pool, among other wonderful amenities.



# NOT-TO-BE-MISSED LAND PACKAGES

## JORDAN

(4 NIGHTS PRE- OR POST-EGYPT)

Discover the fascinating jewels of Jordan, including its capital, Amman, and the UNESCO-designated “Rose City” of Petra; and cap off your journey in Wadi Rum, the timeless “Valley of the Moon.” You’ll be treated to a special lunch at Kan Zaman Castle, visit Mt. Nebo – where Moses first viewed the Promised Land – and marvel at Madaba, “The City of Mosaics.”

## ISRAEL

(4 NIGHTS POST-EGYPT)

From the Dead Sea to incredible sacred wonders, including the Church of the Holy Sepulchre and the Western Wall, there’s no shortage of ways to uncover Israel’s enthralling past and captivating present. Marvel at the Israel Museum’s Dead Sea Scrolls and travel through the Judean Desert to mesmerising Masada, riding a cable car to the top to take in awe-inspiring views of Herod’s more than 2,000-year-old palace fortress and beyond.

## DUBAI AND ABU DHABI, UNITED ARAB EMIRATES

(3 NIGHTS PRE- OR POST-EGYPT)

Explore the vibrant city of Dubai, home to the world’s tallest building, the Burj Khalifa, and a cultural focal point in the Middle East known for luxury shopping, modern architecture and a lively nightlife. Visit the Dubai Museum housed in the Al Fahidi Fort – the oldest existing building in the city, shop in the Gold Souk and Spice Souk and take a desert safari, learning the customs of the desert, including henna painting and belly dancing.



THE TREASURY IN THE ANCIENT CITY OF PETRA, JORDAN



THE OLD CITY AT THE WESTERN WALL AND  
TEMPLE MOUNT, JERUSALEM, ISRAEL



BURJ KHALIFA – THE WORLD’S TALLEST BUILDING  
DUBAI, UNITED ARAB EMIRATES



Scan this QR code  
to learn more



# SECRETS OF EGYPT & THE NILE

RIVER CRUISE & LAND JOURNEY: 12 DAYS/11 NIGHTS

3 nights Cairo, 7-night Nile River Cruise and 1 night Cairo



NILE RIVER, ASWAN, EGYPT

Allow yourself to be treated to a connoisseur's discovery of this ancient civilisation as only AmaWaterways can provide – with an unparalleled 11-night Nile River cruise and land experience. Sail aboard the luxurious *AmaDahlia* or the stunning new *AmaLilia* (2024) and explore ancient wonders, such as the beguiling Temple of Luxor and the mystifying Valley of the Kings and Queens. Plus, come face-to-face with the last survivor of the Seven Wonders of the Ancient World, the Great Sphinx and the three Pyramids of Giza. This unforgettable itinerary includes exclusive experiences, such as a private tour of the tomb of Queen Nefertari and a private lunch and tour at the Abdeen Presidential Palace.





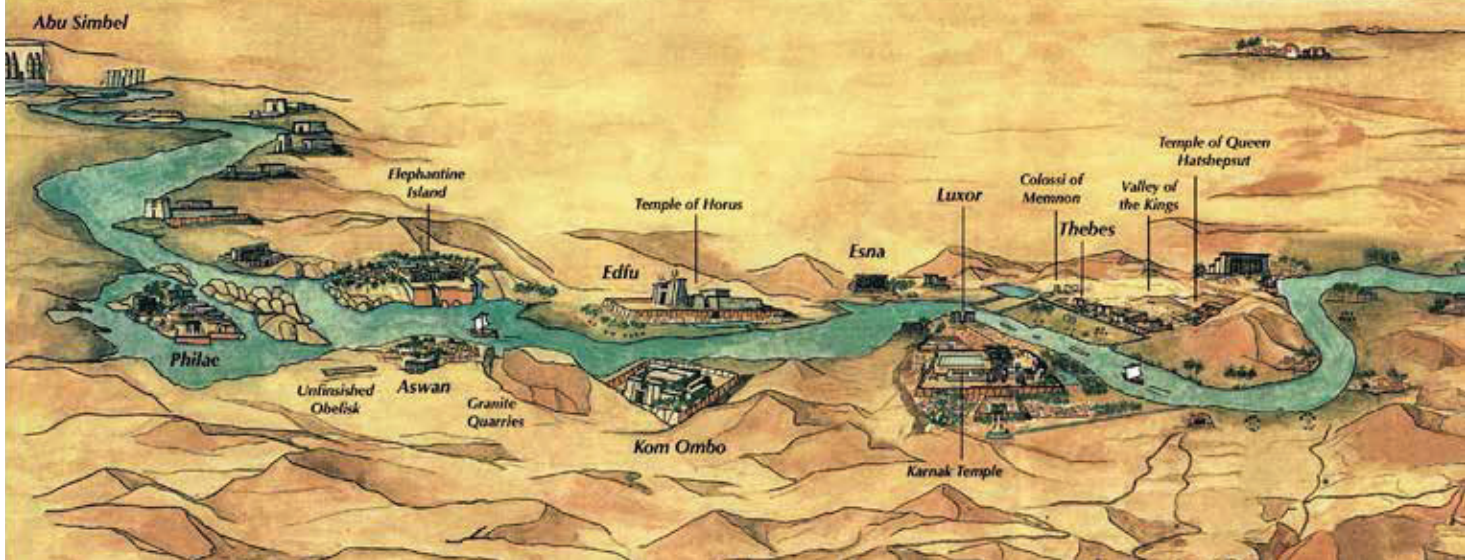

#### RIVER CRUISE & LAND ITINERARY

| DAY | DESTINATION           | INCLUDED EXCURSIONS  |
|-----|-----------------------|--|
| 1   | Arrive Cairo<br>Cairo | Meet and greet on arrival<br>Transfer to hotel   |
| 2   | Cairo                 | Egyptian Museum and King Tut's treasures<br>Local lunch<br>Alabaster Mosque<br>Evening Welcome Reception with tapas and drinks |
| 3   | Cairo                 | Pyramids of Ancient Memphis  |
| 4   | Cairo                 | Coptic Cairo<br>Flight to Luxor  |
|     | Luxor                 | ☀ <b>RIVER CRUISE EMBARKATION</b><br>Free evening  |
| 5   | Luxor                 | Exclusive access to the Tomb of Queen Nefertari<br>Visit Valley of the Kings and Queens  |
| 6   | Edfu                  | Temple of Horus  |
| 7   | Aswan                 | Free morning<br>OR Abu Simbel excursion*<br>Felucca ride around Elephantine Island   |
| 8   | Aswan<br>Kom Ombo     | Nubian Village visit and Philae Temple<br>Great Temple of Kom Ombo<br>Traditional Galabeya evening                             |
| 9   | Luxor                 | Scenic cruising<br>Karnak Temple visit<br>Art of Papyrus making<br>Luxor Temple visit<br>Luxor Market visit                    |
| 10  | Qena                  | Temple of Hathor<br>Cruise back to Luxor   |
| 11  | Luxor                 | ⚓ <b>RIVER CRUISE DISEMBARKATION</b><br>Flight to Cairo  |
|     | Cairo                 | Exclusive Abdeen Palace Private tour and lunch   |
| 12  | Cairo                 | Transfer to airport for your onward flight   |

Shaded area denotes land packages.

\*Guests can reserve the optional tour to Abu Simbel at time of reserving your Nile adventure.

#### RIVER CRUISE WITH LAND JOURNEY 14 DAYS/11 NIGHTS

From C\$6,859 per person

Intra-Egypt Air: from C\$571 per person

All prices are in CAD, per person in a Category E (window) stateroom, based on double occupancy; stateroom upgrades and single supplements are additional.

**2023/2024 Dates:** *AmaDahlia* begins in Cairo most Fridays January through June and September through December. *AmaLilia* begins in Cairo most Mondays March through June and September through December 2024. For the most up-to-date details, including pricing and sailing dates, please visit [AmaWaterways.ca/secrets](https://www.amawaterways.ca/secrets) or contact your travel advisor.



#### OPTIONAL EXCURSION TO ABU SIMBEL

Witness the grandeur of Abu Simbel, a more than 3,000-year-old UNESCO World Heritage Site. Roundtrip airfare, two temple visits and the services of an English-speaking Egyptologist are included.

*Must be pre-reserved before final payment from C\$488 per person.*



# AMADAHLIA

The inviting 72-passenger ship offers 36 standard staterooms, including 16 magnificent suites with a wealth of amenities that will surprise and delight you. Marvel at scenic Nile River views in luxury, enjoy regionally-inspired entertainment and savour the flavours of both local and Western cuisine on board.

## Technical Data

- ◆ Built: 2021
- ◆ Length: 236 ft.
- ◆ Width: 47.6 ft.
- ◆ Staterooms: 36
- ◆ Passengers: 72
- ◆ Crew: 62
- ◆ Registry: Egypt

## Deck Plan

|                      |  |
|----------------------|--|
| <b>Grand Suite</b>   | Lily Deck<br>French & Outside Balcony - 430 sq. ft.                            |
| <b>Deluxe Suite</b>  | Lotus Deck French Balcony &<br>Small Outside Balcony (seats one) - 400 sq. ft. |
| <b>Cat. SA Suite</b> | Lily Deck<br>French & Outside Balcony - 370 sq. ft.                            |
| <b>Cat. SB Suite</b> | Lotus Deck<br>French & Outside Balcony - 370 sq. ft.                           |
| <b>Cat. CA</b>       | Jasmine Deck<br>French Balcony - 226 sq. ft.                                   |
| <b>Cat. CB</b>       | Lotus Deck<br>French Balcony - 226 sq. ft.                                     |
| <b>Cat. E</b>        | Acacia Deck<br>Fixed Window - 194 sq. ft.                                      |

••••• Staterooms separated by a dotted line become connected by request

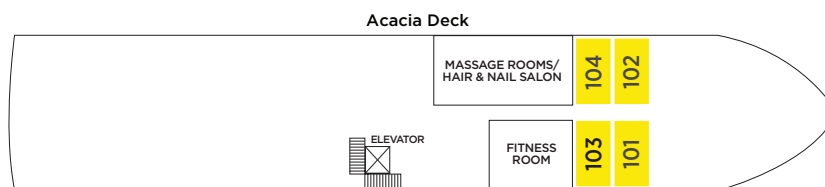
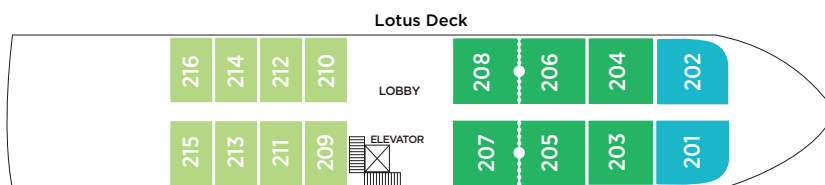
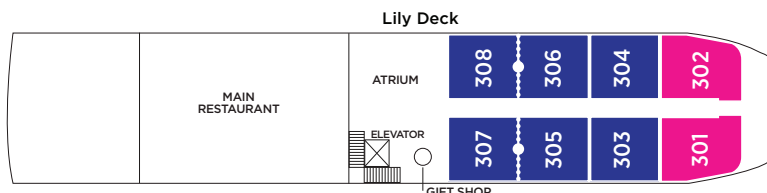
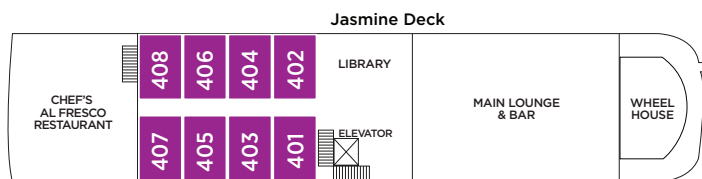
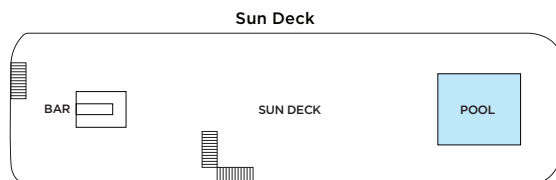

Grand Suite (GS)

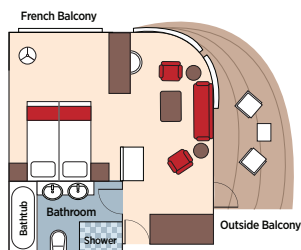

Deluxe Suite (DS)

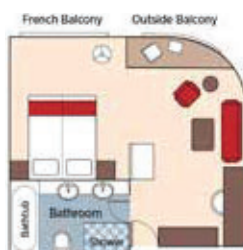

Suite (SA / SB)

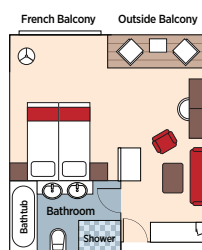

Cat. CA / CB

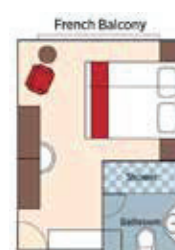

Cat. E

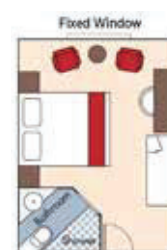



# AMALILIA

When she debuts in 2024, our stunning *AmaLilia* will be a true treasure of the Nile. Specially curated with upscale regionally-inspired décor and 41 staterooms, including 13 marvellous suites, *AmaLilia* will carry you through Egypt in style with the luxurious amenities and exclusive experiences only AmaWaterways provides.

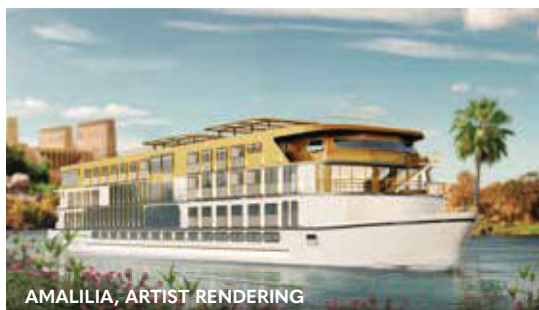

## Deck Plan

|              |  |
|--------------|--|
| Owners Suite | Lily Deck<br>French & Outside Balcony - 522 sq. ft.    |
| Grand Suite  | Jasmine Deck<br>French & Outside Balcony - 430 sq. ft. |
| Luxury Suite | Lily Deck<br>French & Outside Balcony - 430 sq. ft.    |
| Cat. CA      | Jasmine Deck<br>French Balcony - 215 sq. ft.           |
| Cat. CB      | Lotus Deck<br>French Balcony - 215 sq. ft.             |
| Cat. E       | Acacia Deck<br>Fixed Window - 215 sq. ft.              |

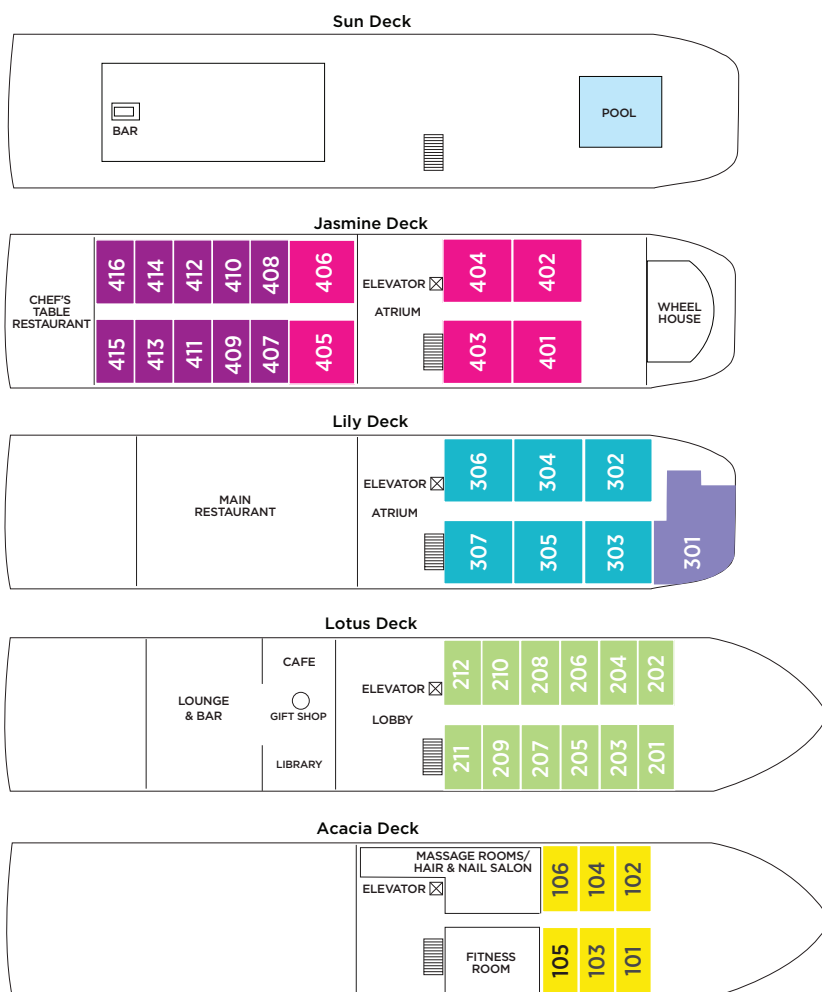

## Technical Data

- ◆ Built: 2024
- ◆ Length: 236 ft.
- ◆ Width: 47.6 ft.
- ◆ Staterooms: 41
- ◆ Passengers: 82
- ◆ Crew: 65
- ◆ Registry: Egypt

